

**OEKO-TEX®  
STANDARD 100  
Excerpt Certificate**



# Excerpt Certificate

## Application guidelines

- Is a **written extract** from an existing and valid OEKO-TEX® STANDARD 100 certificate that corresponds to the content of the article text of the original certificate
- Issued for **specific articles or order numbers** that belong to a larger certified article group (the original certificate)
- In order to issue an excerpt, the articles must be **fully covered by the original certificate**. If the articles are not covered by the original certificate, an extension of the article group is required before an excerpt certificate can be issued
- Excerpts **cannot be renewed or expanded**, it is based on the details of the original certificate
- An excerpt **cannot be used** as a **basic certificate** for a certification

# Excerpt Certificate

## Application areas

- **Product-related** certification
- **Proof of product** certification, e.g. for tenders
- Mainly for ready-made products



# How does an excerpt certificate differ from the original certificate?

- Article description
- Certificate number
- Test report number
- Date of issue

# Certificate content

## Original certificate

Certificate owner & address

Example Customer  
Example Street 33  
33333 City, Country



HOHENSTEIN Textile Testing Institute  
GmbH & Co. KG  
Schlosssteige 1, 74357 Bönningheim,  
Germany

Certificate type

OEKO-TEX® STANDARD 100

Article description

SCOPE:  
White or black polyester/elastane covered yarn (based  
on material partly pre-certified according to  
OEKO-TEX® STANDARD 100)

PRODUCT CLASS:  
I (baby articles) - Annex 6



Product class  
& Annex

This certificate 1234567 is valid until  
31.08.2023.

SUPPORTING DOCUMENTS  
✓ Test report : XX12 34567.8  
✓ Declaration of conformity in accordance with  
EN ISO 17050-1 as required by OEKO-TEX®  
✓ OEKO-TEX® Terms of Use (ToU)

Test report number

John Doe  
Job Title

John Doe  
Job Title

Further compliance information (REACH, SVHC, POP, GB18401  
etc.) can be found on [oeko-tex.com/en/faq](https://www.oeko-tex.com/en/faq).  
The certificate is based on the test methods and requirements of  
the OEKO-TEX® STANDARD 100 that were in force at the time of  
evaluation.

Place, Date

OEKO-TEX Service GmbH Genferstrasse 23, CH-8002 Zurich



Address of the **OEKO-TEX® Institute**  
that issued the certificate

Certificate number & validity date

The certificate is **valid for one year**. A  
certificate can be renewed at the earliest  
90 days before the expiry date.

The validity can also be checked online on  
the OEKO-TEX® website:  
<https://www.oeko-tex.com/en/label-check>

Example Customer  
Example Street 33  
33333 City, Country



HOHENSTEIN Textile Testing Institute  
GmbH & Co. KG  
Schlosssteige 1, 74357 Böttigheim,  
Germany

# Certificate

## OEKO-TEX® STANDARD 100

Example Customer

is granted the OEKO-TEX® STANDARD 100 certification  
and the right to use the trademark.

**SCOPE:**  
White or black polyester/elastane covered yarn (based  
on material partly pre-certified according to  
OEKO-TEX® STANDARD 100)

**PRODUCT CLASS:**  
I (baby articles) - Annex 6



This certificate 1234567 is valid until  
31.08.2023.

**SUPPORTING DOCUMENTS**  
✓ Test report : XX12 34567.8  
✓ Declaration of conformity in accordance with  
EN ISO 17050-1 as required by OEKO-TEX®  
✓ OEKO-TEX® Terms of Use (ToU)

John Doe  
Job Title

John Doe  
Job Title

Further compliance information (REACH, SVHC, POP, GB18401  
etc.) can be found on [oeko-tex.com/en/faq](http://oeko-tex.com/en/faq).  
The certificate is based on the test methods and requirements of  
the OEKO-TEX® STANDARD 100 that were in force at the time of  
evaluation.

Place, Date

# Certificate content Excerpt Certificate

## Certificate number

The certificate number of the original  
certificate is supplemented by # and a  
number for the excerpt: XX.HXX.XXXXXX#1

## Test report number

**Date** when the certificate was issued

## Article description

Example:  
“Article no. (IAN/EAN)\_  
Mens cosy pyjama,  
made of (material) in  
colours xx, incl. (all)  
accessories xx.”



# Case study - initial situation

A clothing company for baby and toddler articles has an OEKO-TEX® STANDARD 100 certificate (see *example for ready-made clothing*). For resale to a retailer, proof is required confirming that the material, colour, print and accessories of the articles are covered by the OEKO-TEX® STANDARD 100 certificate.

The company applies to its OEKO-TEX® Institute for an excerpt certificate for this purpose. This clearly and concisely specifies that the desired articles are certified. The certificate is presented to the retailer in order to fulfil their quality requirements and create trust in the products.

## *Example for ready-made clothing*

### Article group text Original certificate:

**Knitted baby essentials like T-shirt, pyjama set, dress, bodysuit, romper, overall, cardigan, pants, cap, headband, mitten, bib, blanket, burp cloth, washcloth, hooded towel, sleeping bag (including terry) made of cotton, cotton/elastane, cotton/polyester, cotton/polyester/elastane in bleached white, reactive and disperse dyed, pigment printed, partly with wadding made of polyester in white, including accessories (sewing thread, button, woven and printed label, zipper, tape, hook and loop fastener); produced using components partly pre-certified according to OEKO-TEX® STANDARD 100.**

# Case study - process flow

## Example for ready-made clothing

Article group text original OEKO-TEX STANDARD 100 certificate:

Knitted baby essentials like T-shirt, pyjama set, dress, bodysuit, romper, overall, cardigan, pants, cap, headband, mitten, bib, blanket, burp cloth, washcloth, hooded towel, sleeping bag (including terry) made of cotton, cotton/elastane, cotton/polyester, cotton/polyester/elastane in bleached white, reactive and disperse dyed, pigment printed, partly with wadding made of polyester in white, including accessories (sewing thread, button, woven and printed label, zipper, tape, hook and loop fastener); produced using components partly pre-certified according to OEKO-TEX® STANDARD 100.



Are the selected articles included in the product scope of my original certificate?



Yes



Apply for an excerpt now

## Example of an excerpt Artikelbeschreibung

**“Article no. (IAN/EAN) 99999\_ Baby bodysuit, produced from knitted fabric made of cotton/elastane in colour white and pigment printed in rose, including accessories (sewing thread, button, woven and printed label).”**





# Flowchart - YOUR WAY TO APPLY FOR AN EXCERPT!

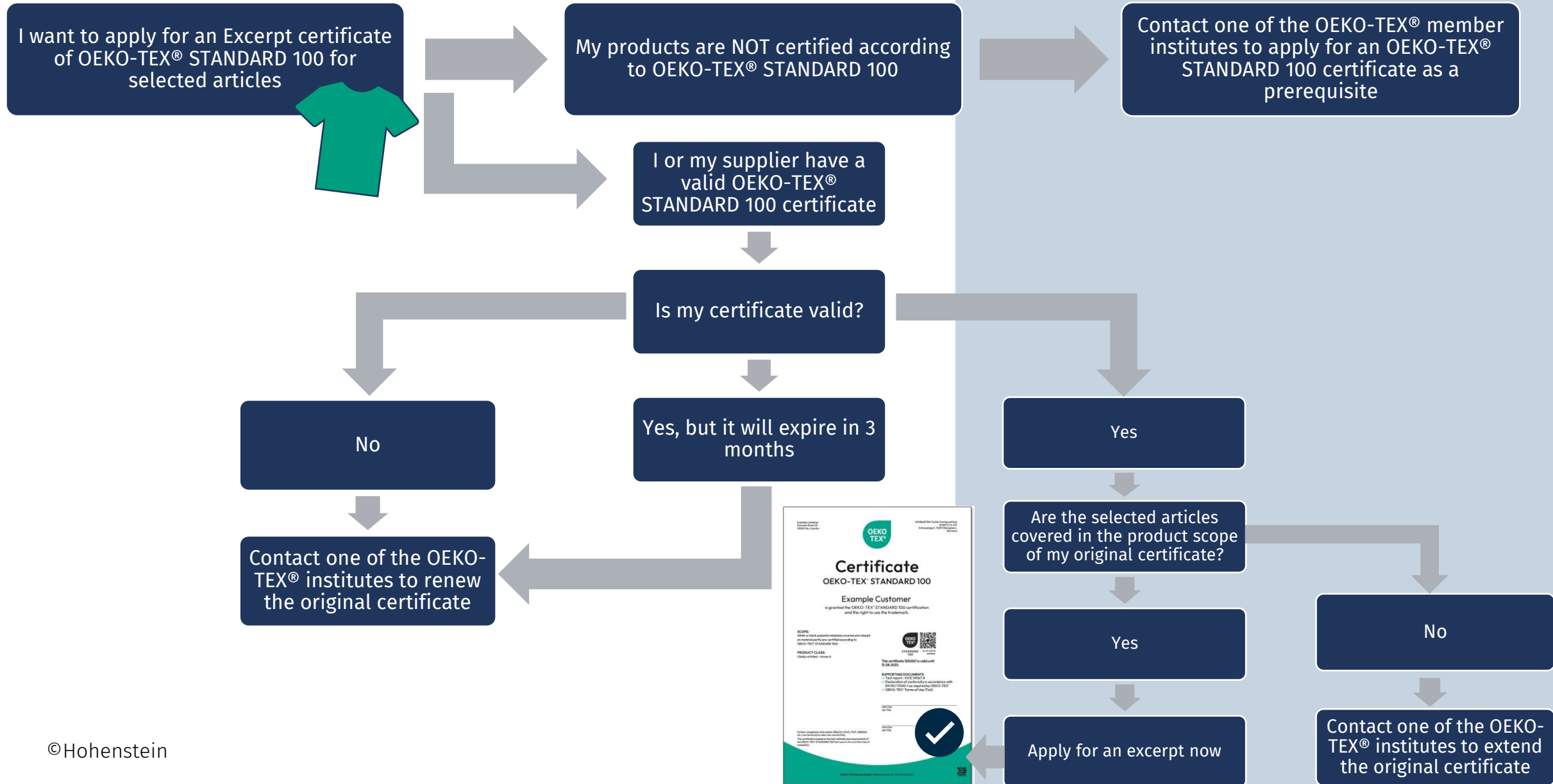

# CERTIFICATION PROCESS - Excerpt

## APPLICANT

**1**  Declaration of conformity  
Supplier certificates and any supporting documents

**2**  Representative sample material or sketches

## HOHENSTEIN

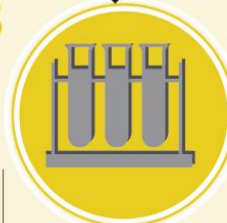
**3**  Creation of individual test plan

**4**  Test of the sample material

**5**  Test samples meet OEKO-TEX® requirements?

**6**  Test report to the company

**7**  **CERTIFICATE**

The **validity date** corresponds to the date of the **original certificate**.

The validity of an excerpt certificate can neither be extended nor can its item description be extended.



HOHENSTEIN

# CONTACT

[oekeo-tex@hohenstein.com](mailto:oekeo-tex@hohenstein.com)

